

User Manual and Parts Guide



Back Pack

Before Using

This manual is furnished with each new V10 Pro and V10 Pro Plus. This provides the necessary operating and preventative maintenance instructions. Operators must read and understand this manual before operating or servicing this machine.

This machine was designed to give you excellent performance and efficiency. For best results and minimal cost please follow the general guidelines below:

- Operate the machine with reasonable care.
- Follow the manufacturer's suggested maintenance instructions as provided in this manual.
- Use original manufacturer's supplied parts.

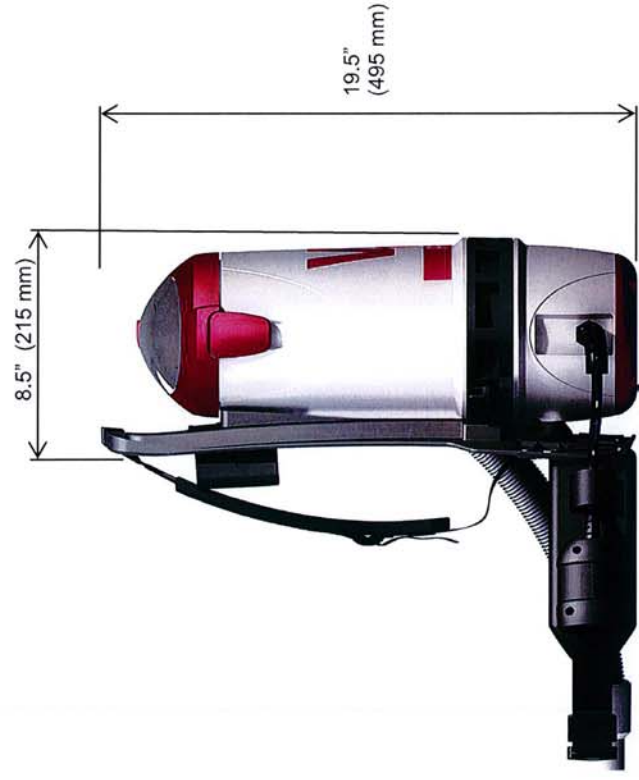

Filtration Efficiency Chart V10115P

Test dust consists of particles between 0-8 micron as per Standard EN 60312.

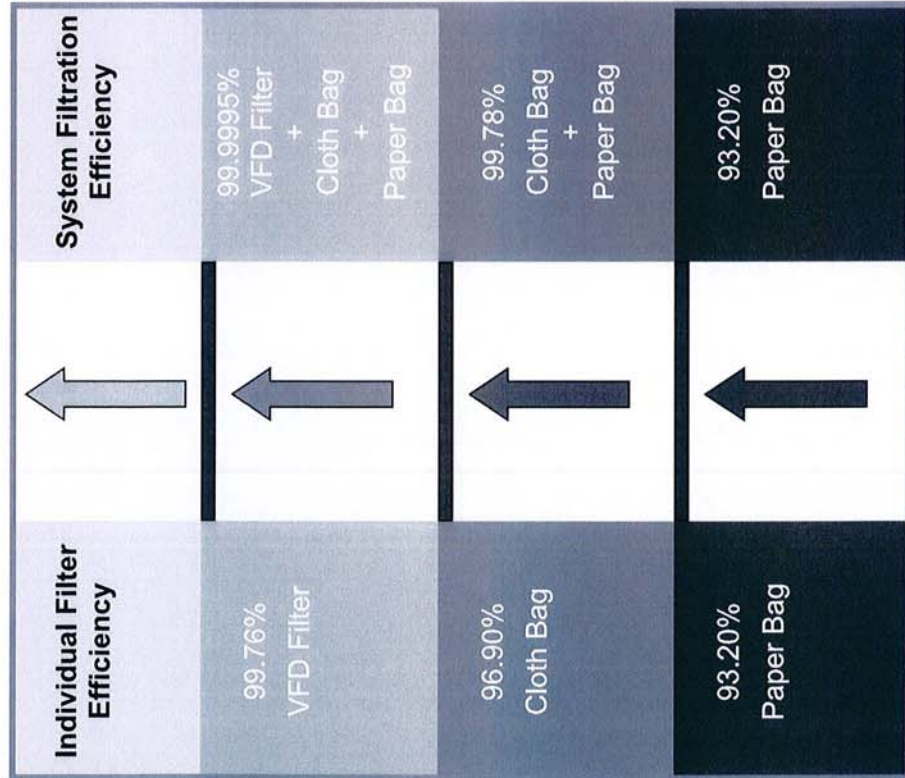

Model: V10 Pro Plus
Model No.: V10115PP

| | V10115P | V10115PP |
|---|------------------------|------------------------|
| Current max. | 10 Amps | 10 Amps |
| Maximum motor power | 1300 W | 1300 W |
| Working width | 10.75" (275mm) | 10.75" (275mm) |
| Weight (exc. Electrical cord and floor tools) | 9.0 lb (4.1 kg) | 9.3 lb (4.2 kg) |
| Noise level average (at 3 ft from surface) | 71 dBA | 69 dBA |
| Voltage/Frequency | 110-120 V / 50-60 Hz | 110-120 V / 50-60 Hz |
| Thermal Control (Manual Reset) | 230F/110C | 230F/110C |
| Air Flow (at nozzle) | 65 cfm (30 l/s) | 65 cfm (30 l/s) |
| Dust Bag | 305 cu.in (5 l) | 245 cu in (4 l) |
| Filtration | Refer chart | 99.97% @ 0.3µm |
| Cord | 50 ft (15m) | 50 ft (15m) |
| Protection | 3-wire ground | 3-wire ground |
| Suction | 80" of water (-20 kPa) | 80" of water (-20 kPa) |



Table of Contents

| | |
|---|-----------|
| Before Using | Page 2 |
| Technical Specifications | Page 3 |
| Safety Instructions | Page 6 |
| Instructions de sécurité | Page 7 |
| Unpacking Instructions and Warnings | Page 8 |
| Déballage des Instructions et Avertissements | Page 9 |
| Machine Overview and Assembly | Page 10 |
| Machine Overview | Page 11 |
| Machine Overview, Wearing and Adjustment | Page 12 |
| Safety and Maintenance Checks | Page 13 |
| Operating and Working | Page 14 |
| Parts Guide and Exploded Diagram | Page 15 |
| Electrical Circuit and Warnings | Page 16 |
| Trouble Shooting | Page 17 |
| Warranty | Page 18 |
| Contact Details | Back Page |

THIS APPLIANCE IS INTENDED FOR COMMERCIAL USE ONLY

IMPORTANT SAFETY INSTRUCTIONS

When using an electrical appliance, basic precautions should always be followed, including the following:

READ ALL INSTRUCTIONS BEFORE USING THE BACK PACK VACUUM CLEANER

- Do not leave the appliance when plugged in. Unplug from the power point when not in use and before servicing.
- Do not use outdoors or on wet surfaces.
- Do not allow to be used as a toy. Close attention is necessary when used by or near children.
- Use only as described in this manual. Use only manufacturer's recommended attachments.
- Do not use with damaged cord or plug. If appliance is not working as it should, has been dropped, damaged, left outdoors, or dropped into water, return it to a service centre.
- Do not pull or carry by cord, use cord as a handle, close a door on cord, or pull cord around sharp edges or corners. Do not run appliance over cord. Keep cord away from heated surfaces.
- Do not unplug by pulling on cord. To unplug, grasp the plug, not the cord.
- Do not handle plug or appliance with wet hands.
- Do not put any object into openings. Do not use with any opening blocked; keep free of dust, lint, hair, and anything that may reduce air flow.
- Keep hair, loose clothing, fingers and all parts of body away from openings and moving parts.
- Turn off all controls before unplugging.
- Use extra care when cleaning on stairs.
- Do not use to pick up flammable or combustible liquids, such as gasoline, or use in areas where they may be present.
- Connect to a properly grounded outlet only. See Grounding Instructions.
- Do not pick up anything that is burning or smoking, such as cigarettes, matches, or hot ashes.
- Do not use without dust bag and/or filters in place.

WARNING!

- No liability can be accepted for damages to persons and or objects caused by improper use, maintenance carried out by unauthorised personnel, use of unauthorised and non original spare parts, any form of tampering and or modifications to the original product.
- The manufacturer reserves the right to modify the appliance and or the accessories supplies without prior notice.

SAVE THESE INSTRUCTIONS

POUR USAGE COMMERCIAL SEULEMENT MODE D'EMPLOI SECURITAIRE

Lorsque l'on utilise un appareil électrique, des précautions de base doivent toujours être suivies telles que:

IMPORTANTES MESURES DE SÉCURITÉ

Toute personne amenée à utiliser ou entretenir cette machine est tenue, auparavant, de lire toutes les instructions et recommandations de ce guide, et de s'assurer de les avoir toutes comprises.

L'utilisation de cette machine à proximité de produits inflammables ou explosifs est formellement interdite. Cette machine a été conçue pour aspirer les poussières et saletés uniquement en intérieur.

Minuteman déconseille fortement toute autre utilisation de sa machine.

Les conditions mentionnées ci-dessous présentent un danger pour l'opérateur et l'appareil. Lisez attentivement ce guide pour réagir de la meilleure façon possible si l'une de ces conditions vient à se produire. Repérez tous les dispositifs de sécurité équipant la machine et prévoyez des sessions de formation pour tous ceux pouvant être amenés à utiliser la machine. Signalez immédiatement tout dommage ou fonctionnement anormal. N'utilisez pas la machine si elle n'est pas en parfaite condition de marche.

IMPORTANTES MESURES DE SÉCURITÉ

L'utilisation d'un appareil électrique demande certaines précautions:

LIRE TOUTES LES INSTRUCTIONS AVANT DE FAIRE FONCTIONNER (CET APPAREIL)

AVERTISSEMENT. Pour réduire les risques d'incendie, de choc électrique ou de blessure :

1. Ne pas laisser l'appareil sans surveillance lorsqu'il est branché. Débrancher lorsque l'appareil n'est pas utilisé et avant l'entretien.
2. Ne pas utiliser à l'extérieur et ne pas aspirer de matières humides.
3. Ne pas permettre aux enfants de jouer avec l'appareil. Une attention particulière est nécessaire lorsque l'appareil est utilisé par des enfants ou à proximité de ces derniers.
4. N'utiliser que conformément à cette notice avec les accessoires recommandés par le fabricant.
5. Ne pas utiliser si le cordon ou la fiche est endommagé. Retourner l'appareil à un atelier de réparation s'il ne fonctionne pas bien, s'il est tombé ou s'il a été endommagé, oublié à l'extérieur ou immergé.
6. Ne pas tirer soulever ni traîner l'appareil par le cordon. Ne pas utiliser le cordon comme une poignée, le coincer dans l'embrasure d'une porte ou l'appuyer contre des arêtes vives ou des coins. Ne pas faire rouler l'appareil sur le cordon. Garder le cordon à l'écart des surfaces chaudes.
7. Ne pas débrancher en tirant sur le cordon. Tirer plutôt la fiche.
8. Ne pas toucher la fiche ni l'appareil lorsque vos mains sont humides.
9. N'insérer aucun objet dans les ouvertures. Ne pas utiliser l'appareil lorsqu'une ouverture est bloquée. S'assurer que de la poussière, de la peluche, des cheveux ou d'autres matières ne réduisent pas le débit d'air.
10. Maintenir les cheveux, les vêtements amples, les doigts et toutes les parties du corps à l'écart des ouvertures et des pièces mobiles.
11. Mettre toutes les commandes à la position ARRÊT avant de débrancher l'appareil.
12. User de prudence lors du nettoyage des escaliers.
13. Ne pas aspirer des liquides inflammables ou combustibles, comme de l'essence, et ne pas faire fonctionner dans des endroits où peuvent se trouver de tels liquides.
14. Ne rien ramasser de ce qui brûle ou de fumée tels que cigarettes, allumettes ou cendres en feu.
15. Ne pas employer sans filer de poussière ou autre en position.
16. Brancher dans une prise avec une prise de terre seulement. Voir références pur prise de terre.

CONSERVER CES INSTRUCTIONS

Inspection

Déballer soigneusement et inspecter la possibilité de tout dommage apparent. Chaque machine est complètement inspectée à l'usine et les dommages de transit sont la responsabilité de la compagnie de transport que devrait être prévenue immédiatement.

Instructions pour prise de terre

Cet appareil doit posséder une prise de terre, S'il y avait malfunction ou brisure, une prise de terre offre une voie de moindre résistance de façon à ce que le courant électrique réduise le risque de choc. Cet appareil est équipé d'une prise de terre de même qu'une prise de courant avec prise de terre. Cette prise doit être déposée dans une sortie adéquate qui sera installée selon les exigences et les lois locales.

Danger

Un mauvais assemblage du conducteur de prise de terre pourrait causer un risque de choc électrique. Vérifier auprès d'un électricien certifié ou d'une personne qualifiée si vous avez des doutes à savoir si la prise est bien complétée. Ne pas modifier la prise qui vient avec cet appareil. Si la prise n'accède pas à la sortie, un électricien qualifié devrait la remplacer.

Cet appareil doit être utilisé sur un circuit de nominal de 115/120 volt et posséder une prise de terre que ressemble à la prise illustrée dans le schéma A. Bien vous assurer que la sortie de courant soit de la même configuration que la prise. Aucun adaptateur ne doit être utilisé avec cet appareil.

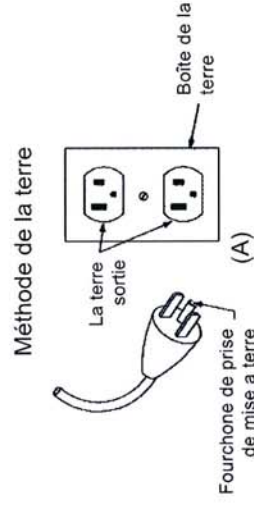

Avertissement

Cet appareil est équipé d'un système de protection de réglage thermique. Il s'agit d'un dispositif pour préserver l'appareil de la surchauffe. Si l'appareil s'arrête subitement et ne redémarre pas, éteignez l'interrupteur principal et débranchez la prise. Attendez au moins 30 minutes avant de le réutiliser.

Machine Overview and Assembly

Machine Overview and Assembly

- A. Lid
- B. Hose Release Button
- C. Inlet Elbow
- D. Back Pad
- E. Shoulder Pads
- F. Shoulder Buckle
- G. Shoulder Strap Guides
- H. Inlet Cord and Socket
- I. Cord Restraint
- J. Waist Pad
- K. Tool Holders
- L. Belt Adjuster
- M. Side Release Buckle
- N. On/Off Remote Switch
- O. Cable Restrainer
- P. Magnetic Latch
- Q. Frame Carry Handle
- R. Hose Inlet
- S. Bent End Piece
- T. Air Regulator (BEP)
- U. Wand (2 Piece)
- V. Ezi-glide Floor Tool
- W. Crevice Tool

Assembly Instructions

1. Connect 2 piece Wand (U)
2. Connect Wand (U) to Bent End Piece (S)
3. Connect Inlet Elbow (C) to Lid (A)
4. Switch on at on/off button (N)

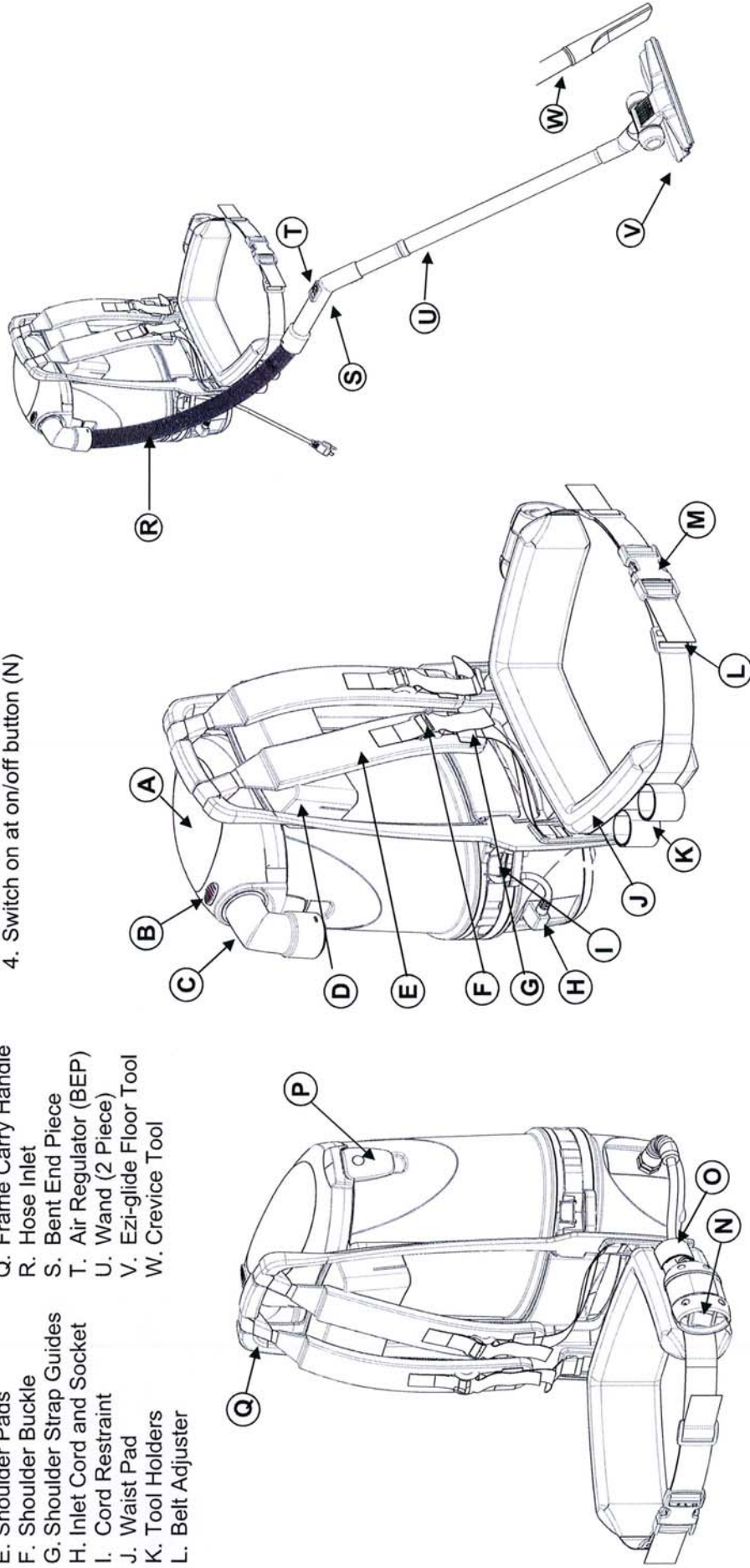

Hose – To Remove

Press Hose Release Button, and gently pull Inlet Elbow from Lid.

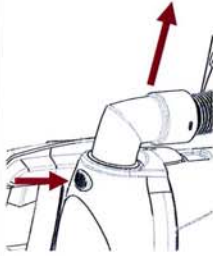

Hose - To Fit

Insert Inlet Elbow into lid opening.

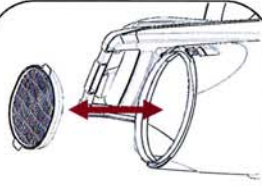

VFD Filter – To Remove

Use the Panel Filter flaps to lift from canister base. Remove with care from the canister.

VFD Filter – To Fit

Insert into canister base filter recess. Press firmly around the edge of the filter to fit into position.

NOTE: Do not press on filter media.

Lid – To Remove

Lift Magnetic Latch opposite side of inlet, rotate Lid away from canister body.

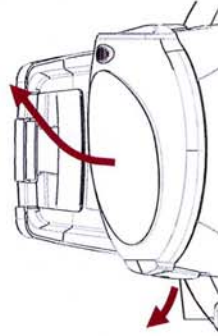

Lid – To Fit

Rotate onto canister body fitting inlet side first, ensuring accurate alignment. Magnetic latch will engage automatically.

NOTE: The lid can be fitted for either left or right operation.

HEPA Filter – To Remove (V10 Pro-Plus Models only)

Loosen Wing Nut on top filter cartridge and remove from canister vertically.

HEPA Filter – To Fit

Locate into Canister Base filter recess, tighten Wing Nut until firm.

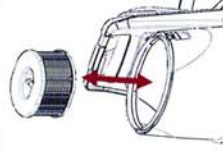

Paper Bag Filter – Removal & Disposal

Ease cardboard retainer off the groove on the Inlet Spout. Fold card board tab over bag inlet hole to prevent spillage. Dispose into garbage bin.

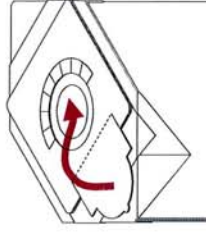

NOTE: The paper bag is manufactured using bio-degradable material.

Cloth Filter Bag – To Remove

Lift from top of canister using bag rim.

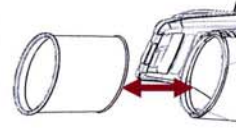

Filter Bag – To Fit

Place over canister rim and press firmly ensuring bag is level.

Paper Bag – To Fit

Align paper bag cardboard, engage non-serrated portion of cardboard (A) into Inlet Spout groove. Ease the remaining serrated portion of cardboard (B) onto groove. Keep corners of paper folded down to avoid entrapment under lid edge.

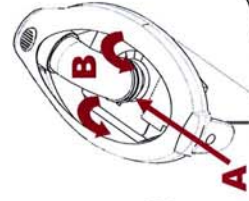

Machina Overview, Wearing and Adjustment

ON/OFF Switch – To Operate

The switch is located on the left hand side of the Waist Pad. Operation is 0/I for OFF/ON.

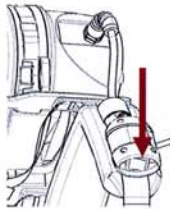

Cord – To Fit

For safety in reducing tripping hazards and for unplugging, fit the cord into integral cord restraint as shown.

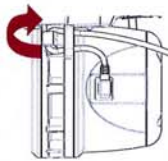

Air Regulator – To Adjust

Slide forward to close, this provides more air at the nozzle. Slide back for less air, this is to be used when vacuuming loose materials eg. curtains.



Attachments – To Fit or Remove.

Twist and pull to disassemble. Attach at any point from Bent End Piece to Wand end, to suit application.

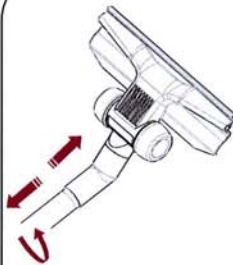

Tool Holder – To Adjust

Size the adjustment loop before wearing to suit the tool to be inserted.

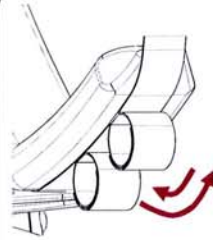

Wearing and Adjustment

Adjusting shoulder and waist pads

Shoulder Pad - to loosen Pull away from the Shoulder Pad, this releases the Strap from the Buckle.

Waist Pad - Preliminary Adjustment

- Feed free end of Strap 1 through belt adjuster 2 to release.
- Feed strap 1 through Buckle 3 to release.
- Adjust Strap 1, Buckle 3, Belt Adjuster 2, to fit approx 1/2 girth of user.
- Belt Adjuster 5 gathers loose end of Strap 4.
- Pull free end of Strap 4 for final adjustment.

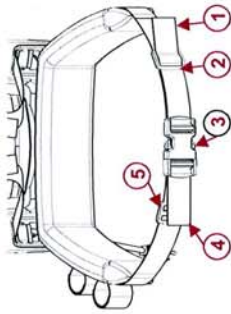
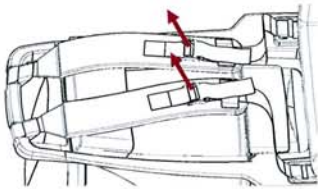

Final Fitting

- Loosen Shoulder Pad and Waist Pad. Lift machine onto one shoulder by the shoulder strap. Insert opposite arm through the shoulder strap by which the machine is lifted. Slide other arm through the remaining strap.
- Position the Waist Pad into the 'small' of your back.
- Clip buckle together and tighten Waist Pad until secure and comfortable.
- Pull down on both ends of the shoulder strap until the Back Pad contacts the back.

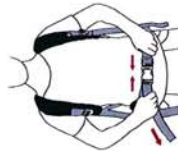
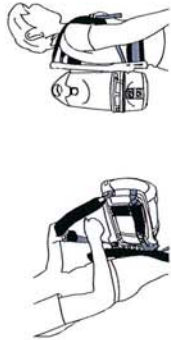

Cloth Bag Filter

Regularly
Remove Cloth Filter Bag and empty.

Occasionally

Turn bag inside out and remove fine dust coating using a soft banister brush or vacuum.

Note: The filter material has been treated with a moisture repelling agent for improved dust release. There is no requirement for washing or dry cleaning the Filter Bag.

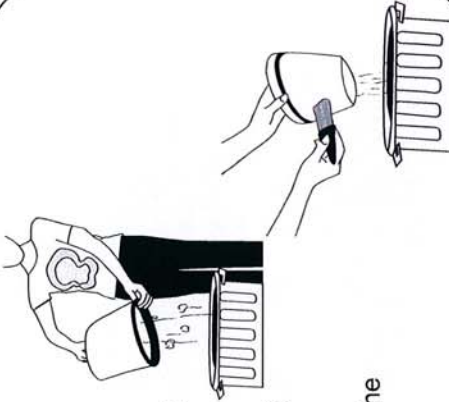

HEPA Filter (where fitted)

Regularly
Remove HEPA filter and tap out dust.

Occasionally

Wash in neutral cleaner solution using swirling action only, then rinse in clean water.

Note: The filter material has been treated with a soft polymer moisture repelling agent, do not touch media surface by hand or any other mechanical device. This can damage the media and impair the filtration quality. Ensure filter is completely dry before recommencing vacuuming.

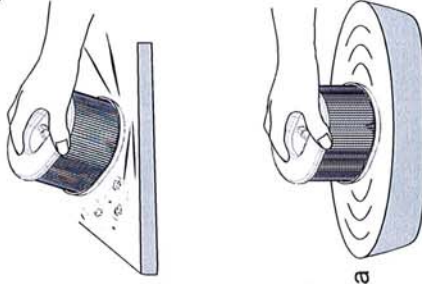

VFD Filter

Regularly
Remove VFD Filter and tap out dust.

Occasionally

Brush surface using a soft nylon brush or wash filter in neutral cleaner solution then rinse in clean water.

Note: Ensure filter is completely dry before recommencing vacuuming.

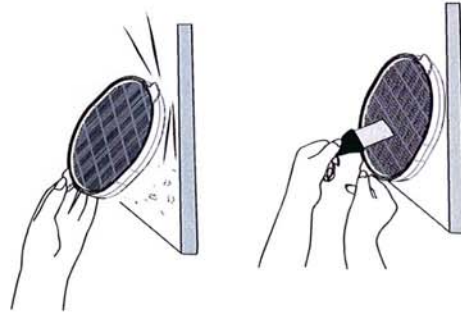

As Needed

Check Inlet Elbow, Hose, Bent End Piece and Floor Tool for blockages.

Regularly

Check cord for cuts, exposed wire, abrasion and knuckling.

Replace cord only with original manufacturer's part.

Note:

Always unplug cord from power point when not in use.

Gather the cord by winding from the machine end.

Drape cord over handle for storage.

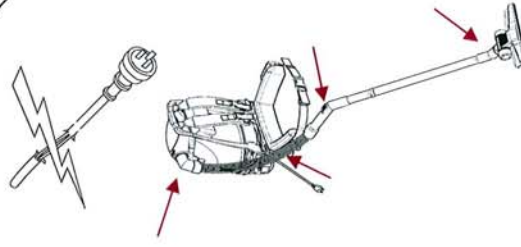

Operation and Working

Using

- For comfortable operation, stand upright with a relaxed posture, arms hanging loosely to the side.
- Maintaining a straight wrist, hold the hand grip section of the wand with one hand, parallel to the floor.
- When vacuuming under office desks, the reach of the wand is sufficient to avoid bending at the waist.
- When vacuuming under lower profile objects or when picking up items off the floor, bend the knees and maintain a straight back.
- When turning, do not twist at the waist. Turn using your feet.

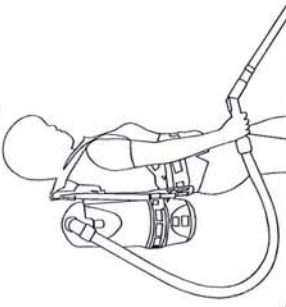
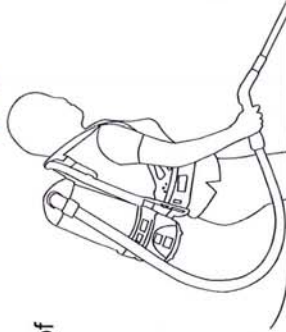

Working

- Plan the work path based on location of the power point, room/furniture layout, and entrance and exit points.
- Commence vacuuming using a systematic approach working one half of the area first, away from the power point, and then the other half of the area, returning back to the start.
- Ensure that the power cord is clear of feet to reduce likelihood of tripping.

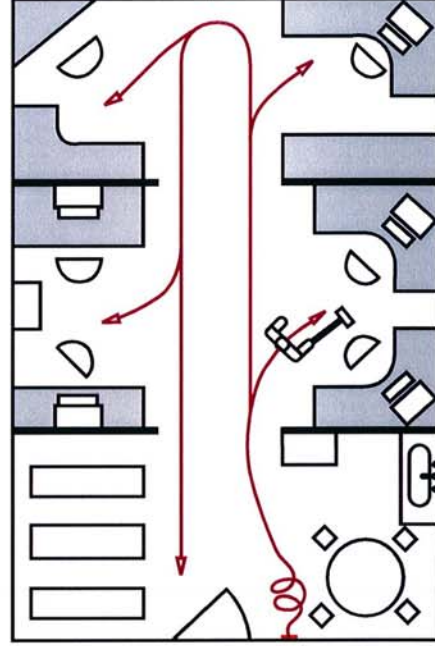

Parts Guide and Exploded Diagram

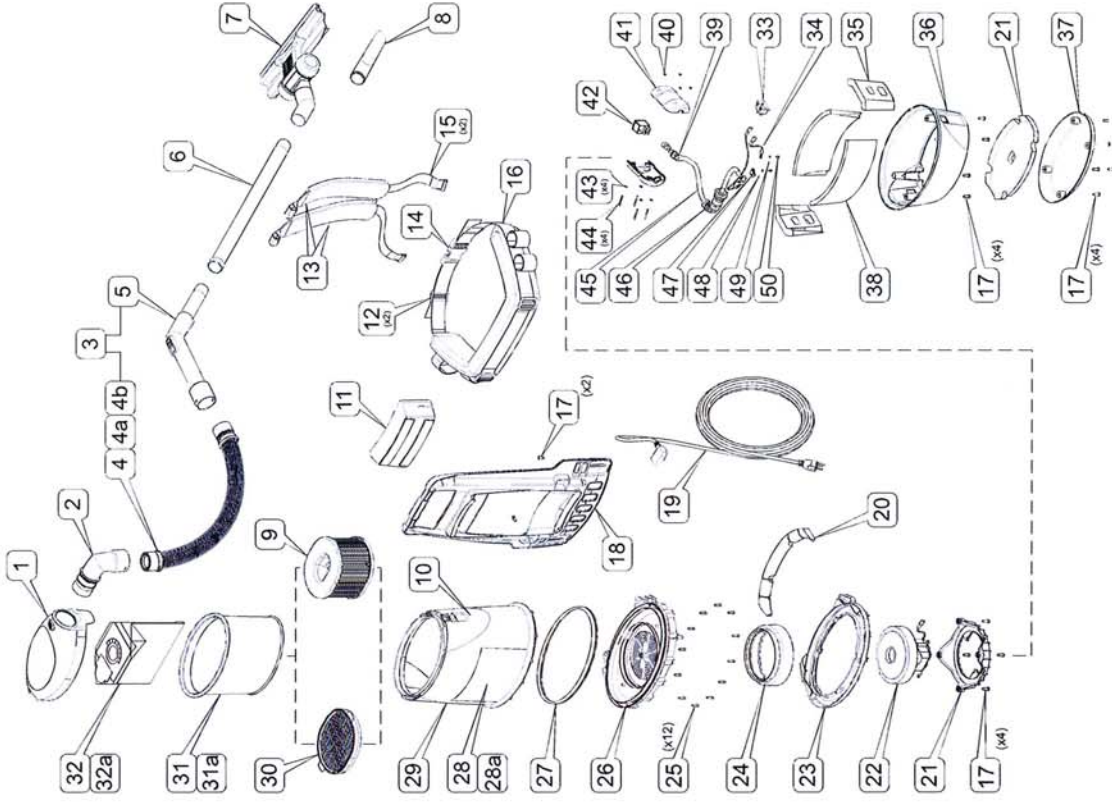

| No. | Part Name | Part No. | No. | Part Name | Part No. |
|-----|------------------------------|----------|-----|-------------------------------------|----------|
| 1 | Lid Assy V10 | 13717001 | 27 | Seal Canister Housing | 13780004 |
| 2 | Elbow Inlet | 13640001 | 28 | Label Pro | 13710007 |
| 3 | Hose BEP Assy Ø32 | 13677002 | 28a | Label Pro Plus | 13710008 |
| 4 | Hose Ø32 x 1.2m Blk | 13670006 | 29 | Housing Upper Canister Assy | 13677001 |
| 4a | Ring Click Blk | 13770003 | 30 | Filter VFD Assy | 13657003 |
| 4b | Fitting Screwed Hose HUL Ø32 | 13650002 | 31 | Filter Bag Assy 5L (standard) | 13657001 |
| 5 | Elbow BEP Ø32 Blk | 13640002 | 31a | Filter Bag Assy 4L (HEPA) | 13657002 |
| 6 | Wand Ø32 x 550mm Cr. Steel | 13820011 | 32 | Filter Paper Bag 5/Pkt (Standard) | 13657006 |
| 7 | Tool Floor Ezi-Glide | 13797001 | 32a | Filter Paper Bag 5/Pkt (HEPA) | 13657007 |
| 8 | Tool Crevice Ø32 Blk | 13790001 | 33 | Socket Inlet C14 | 13780007 |
| 9 | Filter HEPA & Fastener Assy | 13657004 | 34 | Wire E V10 | 13820001 |
| 10 | Label Maintenance USA | 13710010 | 35 | Insulation Motor Housing End | 13680001 |
| 11 | Pad Back Blk | 13750003 | 36 | Housing Lower Canister In & Remote | 13670002 |
| 12 | Buckle Adjuster 38 | 13610006 | 37 | Cap Motor Housing V10 | 13620003 |
| 13 | Pad Shoulder Blk L & R Set | 13750004 | 38 | Insulation Motor Housing Side (set) | 13680002 |
| 14 | Buckle Side Release 38 | 13610005 | 39 | Grommet Strain Relief V10 | 13660001 |
| 15 | Buckle Shoulder LL 38 | 13610007 | 40 | Nut Hex M3 ZP | 13730001 |
| 16 | Pad Waist Blk | 13750005 | 41 | Housing Remote Switch V10 | 13670005 |
| 17 | Screw WN1412 KB50 x 16 ZP | 13780003 | 42 | Switch Rocker 2HP | 13780014 |
| 18 | Frame RV/XP-V10 | 13650001 | 43 | Washer Flat M3 ZP | 13820009 |
| 19 | Cord USA 15m V10 12-04 | 13620008 | 44 | Screw M3x25 Pan Hd. ZP | 13780001 |
| 20 | Insulation End Cap (set) | 13680003 | 45 | Cord Remote Switch V10 | 13620006 |
| 21 | Clamp Motor | 13620005 | 46 | Cord Grip V10 | 13620007 |
| 22 | Motor Vacuum Harbin 120V | 13727001 | 47 | Clamp P Ø8 | 13620012 |
| 23 | Baffle Motor Housing | 13610004 | 48 | Washer 4ID x 9.5OD ZP | 13820012 |
| 24 | Seal Motor Harbin | 13780006 | 49 | Washer M3 Ext. Shakeproof | 13820010 |
| 25 | Screw WN1412 KB40 x 12 ZP | 13780002 | 50 | Screw No.6 x 10 Mush. Hd ZP | 13780016 |
| 26 | Base Upper Canister | 13610003 | | | |

Electrical Circuit and Warnings

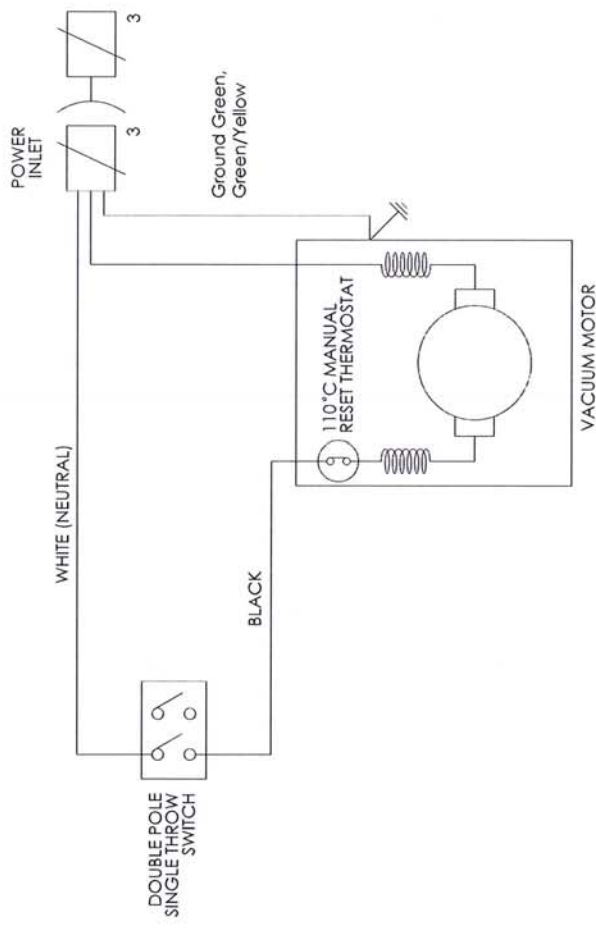

Electrical Circuit

Warnings

Do Not

- Do not vacuum wet surfaces, damp areas or suck up water.
- Do not use machine if water has been picked up by the vacuum system without an electrical inspection by a qualified person.
- Do not vacuum anything that is burning or smoking such as cigarettes, matches or hot ashes.
- Do not use the machine in areas where flammable or combustible liquids, vapors or gas are present.
- Do not operate near explosive materials such as solvents, thinners, fuels or grain dust.



Trouble Shooting

Always switch off machine and unplug prior to correcting any problems. If you are unable to rectify the problem, contact your service agent.

| | |
|---|--|
| Problem: Machine not working | |
| Cause | No power at power point. |
| Solution | Connect machine to a functional power point. |
| Cause | Power cord not plugged into power point or machine. |
| Solution | Check plug is firmly plugged into power supply and machine. |
| Cause | Machine or power supply not switched on. |
| Solution | Turn on/off switch to ON (I). Turn power supply outlet on. |
| Cause | Machine has switched off due to overheating. |
| Solution | Switch off and unplug machine. Check for any blockages in wand, floor tool and inlets. Ensure filters and paper and cloth bags are clean. Wait for 30 minutes and switch machine back on. If machine does not start up, contact service agent. |
| Problem: Poor or No Suction | |
| Cause | Blockage. |
| Solution | Turn off machine and unplug. Check wand, suction hose, floor tool, elbow inlets for obstructions and remove. |
| Cause | Paper or Cloth Filter Bags are full. |
| Solution | Check paper bag and if full, remove and replace. Check Cloth Filter Bag, turn inside out and brush with a soft banister brush before replacing. |
| Cause | Hose not installed properly or damaged. |
| Solution | Check hose connection and ensure it is locked in. Replace if damaged. |
| Cause | VFD Filter is blocked. |
| Solution | Remove VFD Filter and tap gently to remove excess dust before replacing. |
| Cause | Air Regulator needs adjustment. |
| Solution | Close Air Regulator on hose to obtain suction required. |
| Problem: Backpack is Uncomfortable to Wear | |
| Cause | Backpack is not fitted correctly to your body. |
| Solution | Adjust waist bands and shoulder straps as described on page 12 to ensure correct fit. |
| Cause | Pads or straps are worn. |
| Solution | Replace padding/straps. |

Minuteman International Made Simple Commercial Limited Warranty **REVISION F EFFECTIVE 6/1/2009**

Minuteman International, Inc. warrants to the original purchaser/user that the product is free from defects in workmanship and materials under normal use. Minuteman will, at its option, repair or replace without charge, parts that fail under normal use and service when operated and maintained in accordance with the applicable operation and instruction manuals. All warranty claims must be submitted through and approved by factory authorized repair stations.

This warranty does not apply to normal wear, or to items whose life is dependent on their use and care, such as belts, cords, switches, hoses, rubber parts, electrical motor components or adjustments. Parts manufactured by Minuteman are covered by and subject to the warranties and/or guarantees of their manufacturers. Please contact Minuteman for procedures in warranty claims against these manufacturers.

Special warning to purchaser — Use of replacement filters and/or prefilters not manufactured by Minuteman or its designated licensees, will void all warranties expressed or implied. A potential health hazard exists without original equipment replacement.

All warranted items become the sole property of Minuteman or its original manufacturer, whichever the case may be.

Minuteman disclaims any implied warranty, including the warranty of merchantability and the warranty of fitness for a particular purpose. Minuteman assumes no responsibility for any special, incidental or consequential damages.

This limited warranty is applicable only in the U.S.A. and Canada, and is extended only to the original user/purchaser of this product. Customers outside the U.S.A. and Canada should contact their local distributor for export warranty policies. Minuteman is not responsible for costs or repairs performed by persons other than those specifically authorized by Minuteman. This warranty does not apply to damage from transportation, alterations by unauthorized persons, misuse or abuse of the equipment, use of non-compatible chemicals, or damage to property, or loss of income due to malfunctions of the product.

If a difficulty develops with this machine, you should contact the dealer from whom it was purchased.

This warranty gives you specific legal rights, and you may have other rights which vary from state to state. Some states do not allow the exclusion or limitation of special, incidental or consequential damages, or limitations on how long an implied warranty lasts, so the above exclusions and limitations may not apply to you.

Cord Electric Group: Three years parts, two years labor, ninety days travel (Not to exceed two hours)

Exceptions.....

| <u>Model</u> | <u>Parts</u> | <u>Labor</u> | <u>Poly</u> | <u>Travel</u> |
|------------------------------|--------------|--------------|-------------|---------------|
| Port A Scrub | 1 yr | 6 months | 10 yrs | 0 |
| MPV 13 | 1 yr | 0 | 0 | 0 |
| MPV 14 & 18 | 2 yrs | 1 yr | 0 | 0 |
| V Series Upright Vacuums | 1 yr | 1yr | 0 | 0 |
| Rapid Air Blower | 1 yr | 1 yr | 10 yrs | 0 |
| Explosion Proof Vacuum | 1 yr | 1 yr | 0 | 0 |
| X12, X12H & TRS 14 | 1 yr | 1 yr | 10 yrs | 0 |
| E17 & E20 Electric Scrubbers | 1 yr | 6 months | 10 yrs | 0 |
| Pneumatic Vacuums | 3 yr | 1 yr | 0 | 0 |

Description

| <u>Parts</u> | <u>Labor</u> | <u>Poly</u> | <u>Travel</u> |
|---------------------------|--------------|-------------|---------------|
| Battery Operated Group | 3 yrs | 2 yrs | 10 |
| Sweepers | 1 yr | 1 yr | 10 |
| Internal Combustion Group | 1 yr | 1 yr | 10 |

Not to exceed two hours

Exception: PAS 14B

1 yr 1 yr 10 yr 0

Battery Chargers:

One year replacement

Replacement Parts:

Ninety days

Batteries:

0-3 months replacement, 4-12 months pro-rate

Polyethylene Plastic Tanks:

Tanks have 10yr warranty, no additional labor

Minuteman[®]
Excellence Meets Clean



Minuteman International · 14N845 U.S. Route 20 · Pingree Grove, Illinois 60140 USA
Phone 800-323-9420 www.minutemanintl.com

A Member of the Hako Group

988736

Rev * 07/09